

Planting Legend

- | Count | symbol # | Plant Name | Notes |
|-------|----------|---|-------|
| (1) | ⑦ | Rosa 'Altissimo', (Climbing Rose) | - 5G |
| (22) | ⑭ | Tulbaghia violacea variegata, (Society Garlic) | - 1G |
| (3) | ⑰ | Polygala Dalmatisii, (Sweet-Pea Shrub) | - 5G |
| (3) | ⑪ | Cyperus papyrus | - 5G |
| (3) | ⑧ | Fatsia japonica, (Aralia, Japanese) | - 5G |
| (14) | ⑱ | Begonia Richmondensis | - 1G |
| (3) | ⑥ | Dwarf Citrus | - 5G |
| (1) | ③ | Brugmansia 'Charles Grimaldi' (Angel Trumpet) | - 3 |
| (1) | ⑬ | Ficus pumila, (Fig, Creeping) | - 1G |
| (8) | ④ | Strelitzia nicolai, (Giant Bird of Paradise) | - 5G |
| (5) | ⑳ | Miscanthus sinensis, (Grass, Japanese Silver) | - 1G |
| (9) | ⑨ | Phoenix roebelenii, (Palm, Date, Pygmy) | - 5G |
| (12) | ⑩ | Strelitzia reginae (Bird of Paradise) | - 5G |
| (4) | ② | Podocarpus gracillior column | - 15G |
| (20) | ⑮ | Agapanthus africanus 'Elaine', (Lily of the Nile) | - 1G |
| (1) | ① | Santa Rosa Plum | - 15G |
| (2) | ⑫ | Camellia 'Yuletide' | - 5G |
| (6) | ⑲ | Anigozanthos 'Bush Ranger' | - 1G |
| (6) | ⑫ | Echeveria hybrids | - 1G |
| (5) | ⑤ | Hedychium yellow and red, (Gingers) | - 5G |
| (3) | ⑯ | Aloe Vera, (Medicine Plant) | - 1G |
| (4) | ⑭ | Aeonium hybrids | - 1G |

Planting Legend

Remove exist. Birch trees, Oleanders, Xylosma, and Ivy behind backyard block wall
 Remove exist. cement mowstrip in frontyard
 Irrigation System analysis/adjustments required
 Gopher problem, plant in gopher baskets or implement other solution prior to planting
 Mulch all Beds with ES2
 Feed and trim all remaining ivy
 2,774 sq. ft. Planter Beds

Lighting Legend

C- 4 ea. spot light - solar
 B- 12 ea. accent light - solar

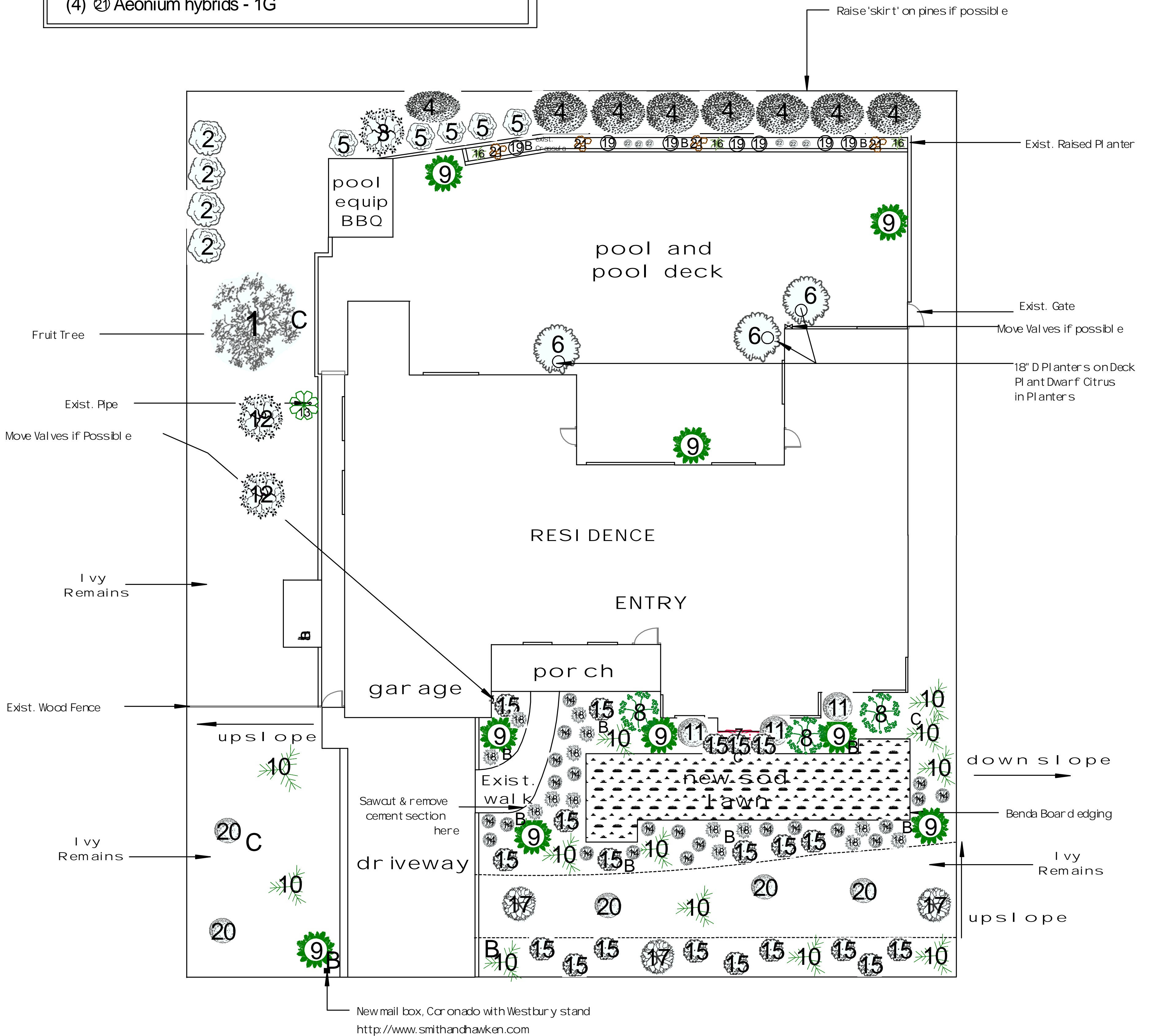

Via Ondulando

All designs are conceptual in nature, they express a two dimensional overview of the ideas discussed during the appointment. Variations in plant material and hardscape work is possible due to availability or client desires. All measurements are to be verified by the client. It is the responsibility of the client to verify all local building codes and setback requirements associated with this design prior to beginning work.

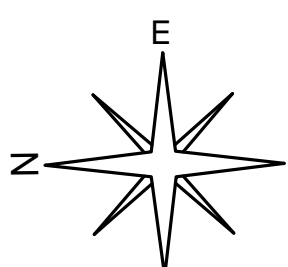

Revision # 2
 Date 1/15/2007
 Scale 1/8" = 1'0"



Pacific Landscape Services
 7568 Santa Rosa Road
 Camarillo, CA 93010
 Tel: 805-484-0085

THE Mc Closkey RESIDENCE
 792 Via Ondulando
 Ventura, CA 93003
 805-654-8295